

**R1305?FKS**

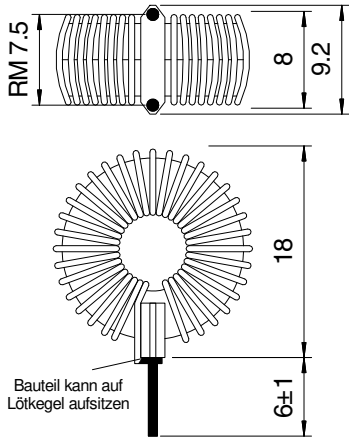

**R1305?S11**

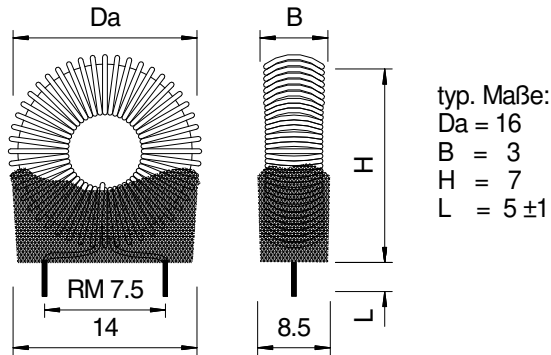

Vor dem Serieneinsatz Lötversuche durchführen!  
 Empf. Löttemperatur/-zeit: ca. (240-260)°C / (2-3)s.  
 Sockelmasse schmilzt beim Durchgang durch Lötbad und fixiert Bauteil auf der Platine.

**R1305?B10**

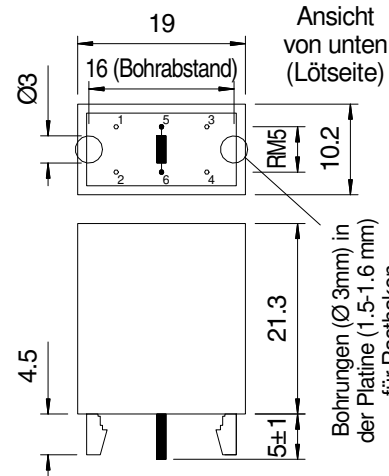

**R1305?11**

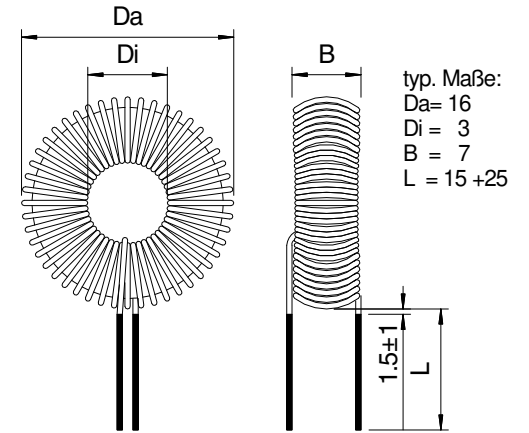

**R1305?B1**

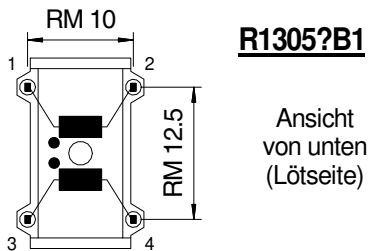

**R1305?B71**

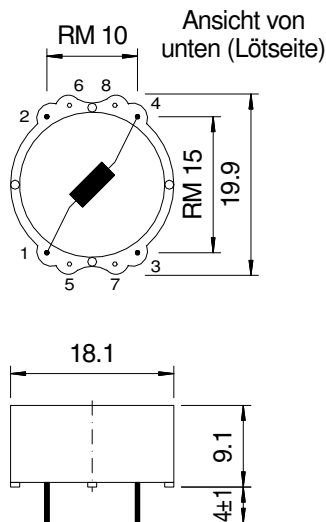

**R1305?L10**

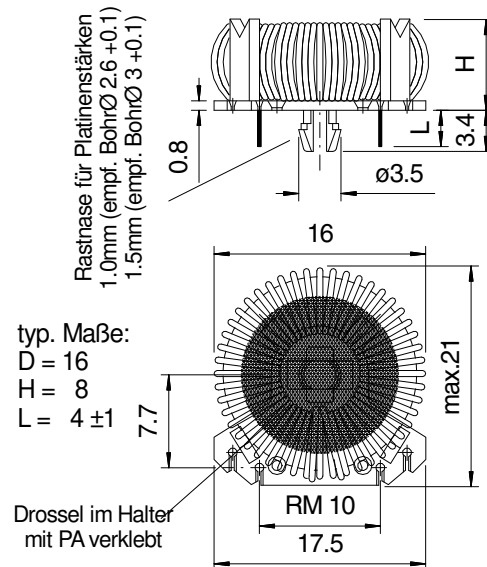

**R1305?10**

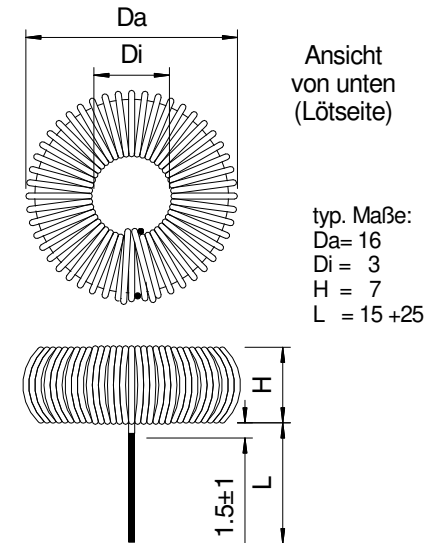

? = mögliche Materialien  
 A, C, D, F, K, L, M